

A = Intersection of Grey Rd. #3 and Victoria St.
 B = Intersection of Caroline St. and Victoria St.
 C = Easterly extent of proposed subdivision and westerly extent of existing road, +/-
 D = Westerly end of proposed subdivision.

A - B = 144 m
 B - C = 312 m
 C - D = 338 m

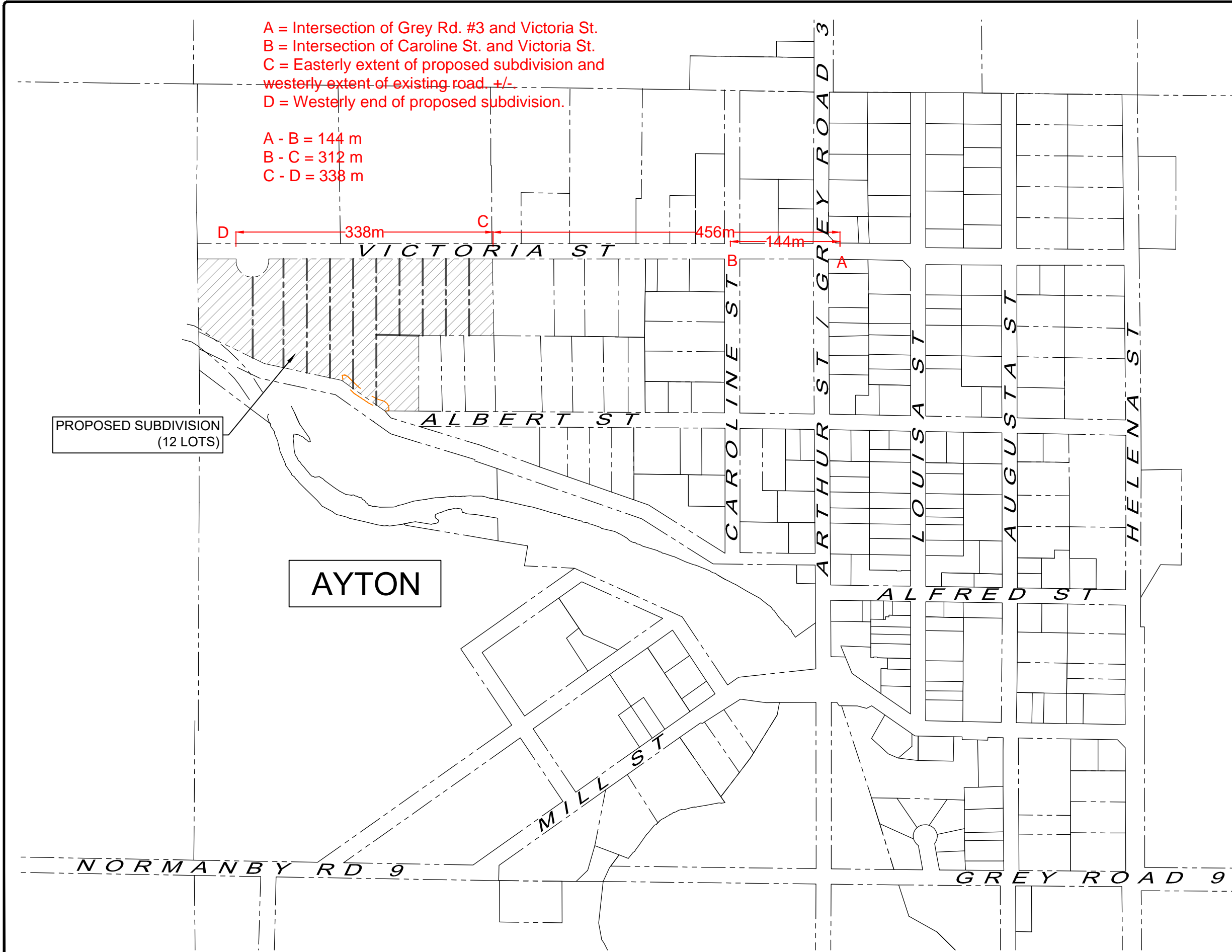
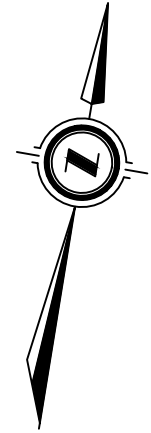

PROPOSED SUBDIVISION
(12 LOTS)

AYTON

No.	DATE	DESCRIPTION	BY	APPD
1	OCT 16/25	FIRST SUBMISSION	JHL	SJC
REVISION / ISSUE				

Title:
 LOTS 3, 4, 5 & 6 SOUTH OF VICTORIA STREET AND
 LOTS 4, 5 & 6 NORTH OF ALBERT STREET
 REGISTERED PLAN No. 153
 MUNICIPALITY OF WEST GREY
 PROPOSED SUBDIVISION

Client:
DOMM CONSTRUCTION

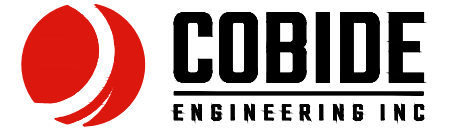

517 10th St, Hanover, ON N4N 1R4
 Telephone: (519) 506-5959
 www.cobideeng.com

Design:	—	Scale:	1:5000
Drawn:	JHL	Approved:	
Checked:	SJC		
Date:	OCT 2025		Design Engineer

DRAWING No. 05069-MAP1